

Écrous à sertir en aveugle HEXATOP-KLSK

acier zingué

tête affleurante | semi-hexagonal | ouvert



DONNÉS
CAO
EN LIGNE

Série
893

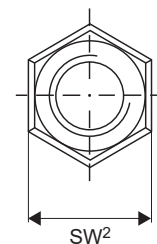
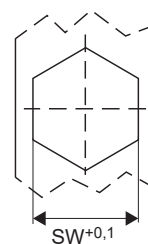
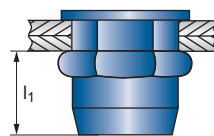
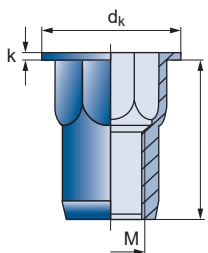

C4C [1.0303]

M	$\frac{I}{M}$	I	N°	
M4	0,3 - 1,5	12,0	10893040150/895	500
SW 6,0		k 0,5	l ₁ max. 6,5 ↻ 3 Nm ⬆ 5400 N	
M5	0,3 - 1,5	13,0	10893050200/895	500
SW 7,0		k 0,5	l ₁ max. 9,0 ↻ 6 Nm ⬆ 9000 N	
M6	0,3 - 1,5	16,0	10863060250/895	500
SW 9,0		k 0,6	l ₁ max. 10,0 ↻ 11 Nm ⬆ 15000 N	

M	$\frac{I}{M}$	I	N°	
M8	0,5 - 3,0	17,5	10893080300/895	250
SW 11,0	SW ²	k 0,6	l ₁ max. 11,5 ↻ 20 Nm ⬆ 20000 N	
M10	0,5 - 4,5	21,0	10893100450/895	250
SW 13,0	SW ²	k 0,7	l ₁ max. 12,5 ↻ 32 Nm ⬆ 30000 N	