

Serie  
**892**

CAD  
DATEN  
ONLINE



# Blindnietmutter HEXAFORM-KLSK

Stahl verzinkt

Kleiner Senkkopf | Sechskantschaft | offen

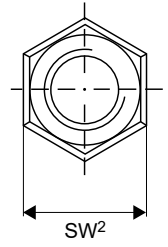
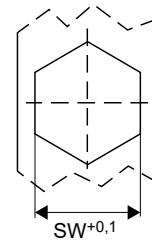
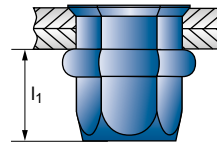
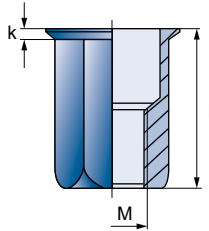

C4C [1.0303]

M		l	Nr.		€/ 1.000
<b>M4</b>	0,3 - 2,0	11,0	10892040200	500	202,48
	2,0 - 4,0	13,5	10892040400	500	240,44
<b>SW 6,0</b>	<b>SW<sup>2</sup> 6,6</b>	<b>k 0,5</b>	<b>l<sub>1</sub> max. 6,5</b>	3 Nm	5000 N
<b>M5</b>	0,3 - 2,5	14,0	10892050250	500	231,78
	2,5 - 5,0	16,0	10892050500	500	266,34
<b>SW 7,0</b>	<b>SW<sup>2</sup> 7,7</b>	<b>k 0,6</b>	<b>l<sub>1</sub> max. 9,0</b>	6 Nm	9000 N
<b>M6</b>	0,8 - 3,0	15,5	10892060300	500	321,88
	3,0 - 5,0	18,0	10892060500	500	347,31
<b>SW 9,0</b>	<b>SW<sup>2</sup> 9,8</b>	<b>k 0,8</b>	<b>l<sub>1</sub> max. 10,0</b>	11 Nm	16000 N

M		l	Nr.		€/ 1.000
<b>M8</b>	0,5 - 3,5	20,0	10892080350	250	415,15
	3,5 - 5,5	20,0	10892080550	250	520,73
<b>SW 11,0</b>	<b>SW<sup>2</sup> 11,8</b>	<b>k 0,8</b>	<b>l<sub>1</sub> max. 11,5</b>	20 Nm	25000 N
<b>M10</b>	1,0 - 3,5	22,5	10892100350	250	648,21
	3,0 - 6,0	23,5	10892100600	250	713,60
<b>SW 13,0</b>	<b>SW<sup>2</sup> 14,3</b>	<b>k 0,9</b>	<b>l<sub>1</sub> max. 16,5</b>	55 Nm	36500 N
<b>M12</b>	1,0 - 4,0	24,5	10892120400	100	814,84
<b>SW 16,0</b>	<b>SW<sup>2</sup> 17,3</b>	<b>k 0,9</b>	<b>l<sub>1</sub> max. 17,5</b>	85 Nm	55000 N